



## *Operating manual*

---

### **AUSTRALIA :**

Atlantic Australasia Pty Ltd  
4/13-25 Church Street  
Hawton Victoria Street - Australia  
Free call : 18 00 67 78 57  
Phone : 03 98 52 95 99  
Fax : 03 98 52 98 94

Web : [www.atlantics.com.au](http://www.atlantics.com.au)  
Email : [sales@atlantics.com.au](mailto:sales@atlantics.com.au)

### **NEW ZEALAND :**

Phone : 0800 422 000  
Fax : 04 38 00 509

Web : [www.atlantics.co.nz](http://www.atlantics.co.nz)  
Email : [sales@atlantics.co.nz](mailto:sales@atlantics.co.nz)



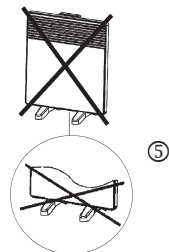
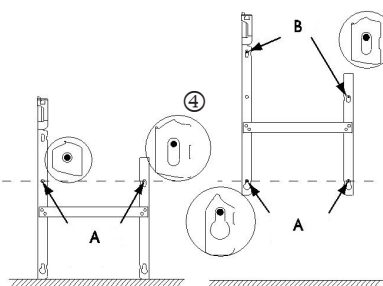
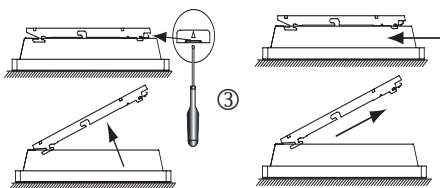
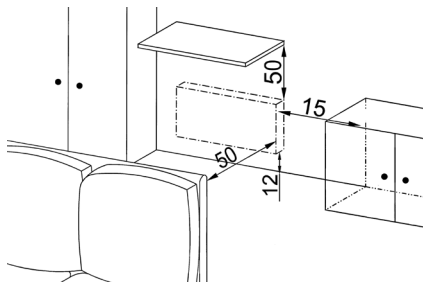
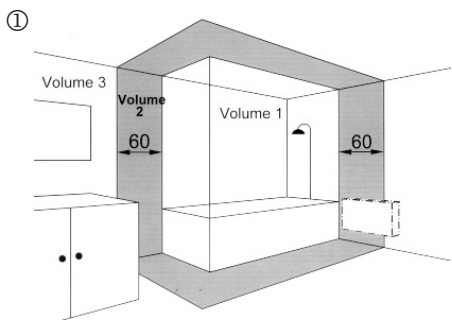

Feet and castors not to be fitted on high and plinth models

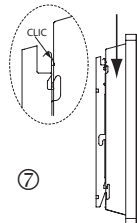
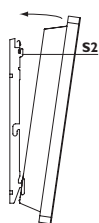
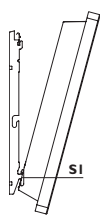
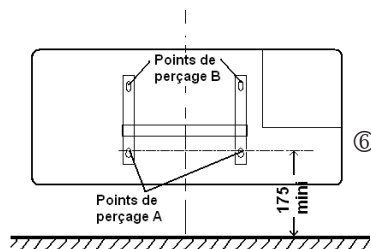

RANGE ARTISAN

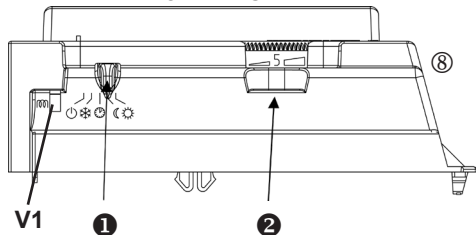

RANGE ODYSSÉE

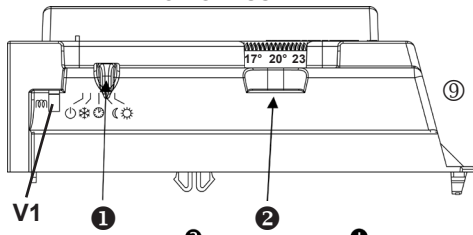

RANGE RIO

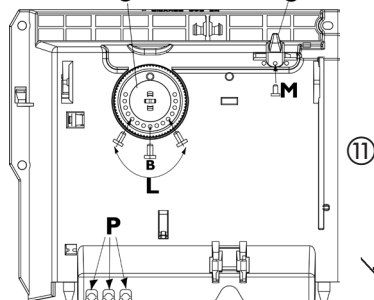
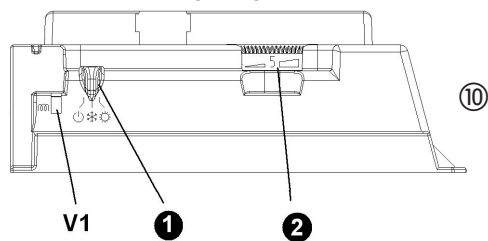

The product you have just purchased has undergone numerous tests and inspections to guarantee the highest quality. We hope it will give you entire satisfaction.

## INSTALLATION OF THE PANEL HEATER

Please read the instructions before starting to install the heater. Disconnect the power before carrying out any work on the heater. Keep these instructions even once you have installed your heater.

### 1) Where to install your heater ?

- This equipment was designed to be installed in a residence. Please ask your distributor before using it for any other purpose.
- The panel heater should be installed according to normal trade practice and in compliance with legislation in the relevant country (the IEE Wiring Regulations).
- The device is to be installed so that switches and other controls cannot be touched by a person in the bath or shower, except in the UK where IEE Regulations 701.512.2 and 701.512.3 apply. These allow the use of IP24 rated products and their integral controls in Zone 2 and outside zones.
- Comply with the minimum clearance distances for positioning of the panel heater. ②
- If your wall covering is laid on foam, a spacer the same thickness as the foam must be placed under the panel heater's support. This ensures there is free space behind the panel heater to make sure its control settings are not adversely affected.
- **Do not install the panel heater:**
  - ⇒ In a draught likely to affect the control settings (under a fan, etc.).
  - ⇒ Under a fixed mains power socket.
  - ⇒ In volume 1 of bathrooms.



It is strongly recommended not to install vertical products we manufacture above an altitude of 1000 metres. If the device is installed at altitude the air discharge temperature will be increased (by approximately 10°C per 1000 m of altitude).  
It is forbidden to install vertical product in horizontal position.

### 2) How to install the panel heater ?

#### 2-1) Release the appliance's hook-on bracket ③

We recommend that you place the radiant panel flat, face down.  
Have a straight head screwdriver to hand.

#### 2-2) Fix the hook-on bracket to wall ④

##### Drilling points A

##### Drilling points B

**Note :** Do not use the device in mobile or feet or on casters ⑤, except the range kit feet (ref. 417010 - 417015 - 417020) and Australian feet & castor (572000).

#### 2-3) Connecting the panel heater

- The panel heater must be powered with 220-240V 50Hz
- The panel heater must be connected to the mains, either by a 2-wire cable (Brown = Phase, Blue = Neutral) via a power socket.

In humid areas such as bathrooms and kitchens the power socket must be installed at least 25 cm above the floor.  
The installation must be equipped with a omnipole disconnection mechanism with a break contact distance of at least 3mm.

**- Earthing is prohibited. Do not connect the pilot wire (black) to earth.**

- The heater must be installed by a qualified electrician in accordance with the local regulations. The heater and the pilot wire (black) must **NOT** be connected to earth. If the heater wire is damaged, it must be replaced by a qualified person to avoid hazard.

If a pilot or piloted panel heater is protected by 30mA differential (e.g. bathroom) the pilot wire's power must be protected on this differential.

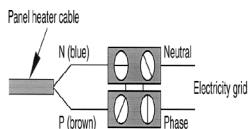

Commands received	No current	Complete alternation 230 V	Négative half-alternation - 115 V	Positive half-alternation + 115 V
Oscilloscopes Réf/Neutral				
Mode obtained	COMFORT	ECO	ANTI-FREEZE	POWER CUT STOP

#### 2-4) Lock the appliance on the hook-on bracket

# USING THE PANEL HEATER

## 1) Description of the control unit : ⑧

- ① → Mode cursor.    ② → Temperature adjustment control dial.    V1 → Heating indicator light

## 2) Fixing the comfort temperature

The comfort setting is the temperature that is preferred during times the room is occupied.

- Slide the switch ① cursor to .
- Adjust the control dial ② to the preferred position, the heating light V1 indicates if the temperature drops below the preferred on the control dial ②.
- Wait a few hours for the temperature to stabilise.
- If the setting is satisfactory (if necessary use a thermometer to check), mark the position for future use.
- If the setting is not satisfactory, adjust it and start again from point c.

## 3) Fixing the Eco temperature : ☾

The Eco setting reduces the temperature setting by 3 to 4 degrees. The Eco setting can be used when the room is unoccupied for more than 2 hours.

- Slide the switch ① to ☾.
- Adjust the control dial ② to the preferred position, the heating light V1 indicates if the temperature drops below the temperature set on the control dial ②.
- Wait a few hours until the temperature stabilizes.

Note : When switching n°1 (on the picture) is set on Programming system (clock symbol) with the PassProgram On/Off, please refer to paragraph n°8.

## 4) Frost-Free mode

This mode is used to keep the temperature at approximately 7°C in the room when you are absent from the house for a prolonged period (i.e. more than 24 hours).

- Set the ① switch on .

## 5) The heating indicator : V1

This light comes on when the heating element is working. It may flash when the temperature has stabilised.

## 6) Locking the controls : ⑨

It is possible to lock or limit use of the ② control dial and lock the ① switch to prevent unauthorised manipulation of the panel heater (children, etc.).

- Unhook the panel heater from its wall mounting.
- Remove the pins **P** on the back of the thermostat casing.
- Select position **B** to lock the control dial or position **L** to limit the amount it can be turned. Position **M** blocks the switch for Electronic Model.

## 7) Using the pilot wire : ⌚

The product with pilot wire can receive the following signals from a master unit :

- comfort (temperature of ② control dial)
- eco (comfort temperature -3°C to -4°C)
- frost free (approximately 7°C)
- off.

Put the switch ① to the programming mode ⌚.

The product must be connected through the pilot wire to a programming control or a product equipped with pass program system in order to use these different modes. You can control several convectors with a single programmer or a product equipped with pass program system.

**Warning:** When the programme turns to Frost Free or Off in the main programming system or using a Pass Program system, these functions will override the manual switch of the Panel Heater.

## 8) Using the On/Off PassProgram system. Ref 602019

When using programming mode (clock symbol) with the on/off pass program system (interface + timer), the moon symbol on the timer refers to the off mode (no heating).

**Important :** If the timer (602019) is set to off, this function will override the slide switch 1 modes (eco, comfort & frost free) on the heater.

## RECOMMENDATIONS FOR USE

- There is no point in setting maximum heating, the room temperature will not rise any quicker.
- When you air the room, disconnect the panel heater by putting the ① switch to off ☾.
- If you leave the room for several hours slide the switch ① to ☾ eco position.  
Absence for: **less than 2 hours**, set the cursor ① switch knob to moon ☾.  
**2 to 24 hours**, either you can lower the control dial ② by two graduations, select eco mode ☾ or switch to off ☾.
- If you have several units in a room, let them operate simultaneously. This will give you a more uniform temperature without increasing electricity consumption.

## WARNINGS



Children must not lean on the appliance. Under certain circumstances, there is a risk that its surface may cause burns to the skin of young children. If there is any risk of this at all, install a protection grill. This device is not intended for use by persons (including children) with physical, sensory or mental disability, or by persons lacking experience or knowledge, unless they have received from a person in charge of their safety adequate supervision or preliminary instructions on how to use the device.

Care must be taken at all times to keep children from playing with the device.

Do not introduce objects or paper into the device.

Do not totally or partially block the grilles on the front or inside of the appliance, as this may cause overheating. If the supply cord is damaged, it must be replaced by a service agent or similarly qualified person in order to avoid a hazard (applies to all units). All work to the inside of the appliance must be carried out by a licensed electrician.

## MAINTENANCE

To maintain performances of your unit, you should clean the upper and lower grilles of the unit about twice a year using a vacuum cleaner or a brush.

Have a professional check the inside of the unit every five years.

Dirt may collect on the grille of the unit if the atmosphere is polluted. This phenomenon is due to the poor quality of the ambient air. In this case, it is recommended to check that the room is well ventilated (ventilation, air inlet, etc.), and that the air is clean. The unit will not be replaced under the guarantee because of this type of dirt.

The unit casing should be cleaned with a damp cloth, never use abrasive products.

## TROUBLE-SHOOTING

### If the unit does not heat :

Check that the programmer is in COMFORT mode (electronical).

Make sure that the installation circuit breakers are switched on, or that the load shedder (if you have one) has not switched off the unit power supply. Check the air temperature in the room.

### The unit does not carry out programming orders : (version with pilot wire)

Make sure that the programming unit is being correctly used (refer to its user's manual) or that the Chronopass is properly inserted in its housing and that it is operating normally (batteries ?).

### The unit is permanently heating :

Make sure that it is not in a draft and that the temperature setting has not been changed.

This unit with electronic control is equipped with a microprocessor that can be disturbed by some severe mains voltage disturbances (outside EC standards defining the disturbance protection level). If there are any problems (thermostat blocked, etc.) switch off the unit power supply (fuse, circuit breaker, etc.) for about 5 minutes to allow the unit to start again.

**Have your energy distributor check your power supply if the phenomenon occurs frequently.**

## WARRANTY CONDITIONS :

### KEEP THIS DOCUMENT IN A SAFE PLACE

*(This certificate should only be produced if you are making a complaint, attached with the invoice of the purchase)*

- This guarantee is applicable for 7 years from the date of original purchase.

- Your Atlantic distributor will exchange parts shown to be defective in manufacture. The replacement parts will be of charge but Atlantic does not accept responsibility for freight or labor charges or losses in transit.

- This guarantee excludes damage by neglect, shipping or accident and any damage due to incorrect installation, use or purposes other than those intended or failure to observe the instructions.

- Atlantic Australasia Pty Ltd reserves the right to reject any warranty claims used in conditions other than domestic purposes or connected to non Australasia and New Zealand approved power boards, extension leads, double adaptors and power outlets.

UNIT TYPE \* : \_\_\_\_\_

SERIAL NUMBER \* : \_\_\_\_\_

CUSTOMER'S NAME AND ADDRESS : \_\_\_\_\_

**\* This information is shown on the plate which can be seen on the left-side or behind the front grille of the unit.**

### FOR SALES IN NEW ZEALAND

ATLANTIC AUSTRALASIA - Phone : 0800 422 000 - Fax : 04 38 00 509

Web : [www.atlantics.co.nz](http://www.atlantics.co.nz) - Email : [sales@atlantics.co.nz](mailto:sales@atlantics.co.nz)

### FOR SALES IN AUSTRALIA

ATLANTIC AUSTRALIA Pty Ltd

4/13-25 Church Street

Hawthorn Victoria Street – Australia

Free call : 18 00 67 78 57

Phone : 03 98 52 95 99 - Fax : 03 98 52 98 44

Web : [www.atlantics.com.au](http://www.atlantics.com.au)

Email : [sales@atlantics.com.au](mailto:sales@atlantics.com.au) - web : [www.atlantics.com.au](http://www.atlantics.com.au)

INSTALLER'S STAMP



