

FR

Convecteur

Notice d'installation et d'utilisation - Guide à conserver par l'utilisateur

GB

Convector

Documentation for installation and use - The user must conserve this guide

D

Wandkonvektoren

Anstellungs- und Bedienungsanleitung - Nützliche hinweise-
Vom Benutzer aufzubewhren

NL

Convectoren

Installatie- en gebruiksvoorschriften - Richtlijnen te bewaren door de gebruiker

SP

Convectores

Instrucion u de utilizacioin - Guia a conservar por el usuario

P

Convectores eléctricos/mecânicos

Instruções de instalação e de utilização - Guia a conservar pelo utilizador

RUS

КОНВЕКТОРЫ

Руководство по установке и эксплуатации – Руководство пользователя

PL

Konwektory

Instrukcja montazu i obslugi –Instrukcja, którą użytkownik powinien zachować

EST

Konvektor

Paigaldus-ja kasutusjuhend – Juhend kasutajale

LI

Konvektoriai

Instaliavimo ir naudo jimosi instrukcija - Vadovas, kuri vartotojas ruri issaugoti



Nous réchauffons l'avenir depuis longtemps

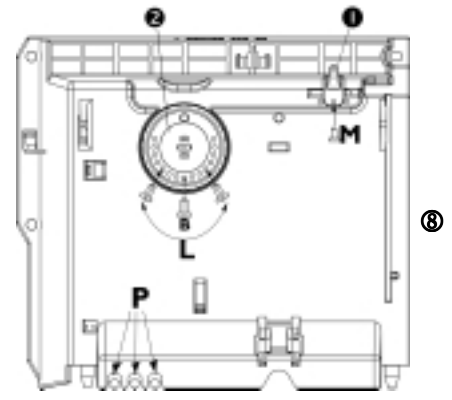
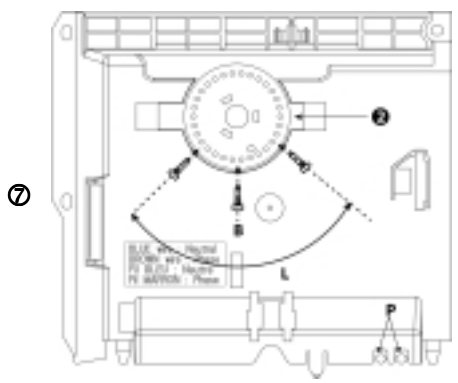
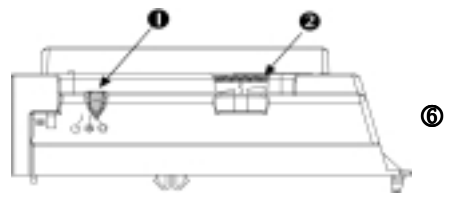
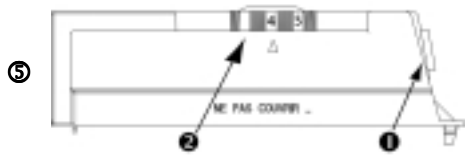
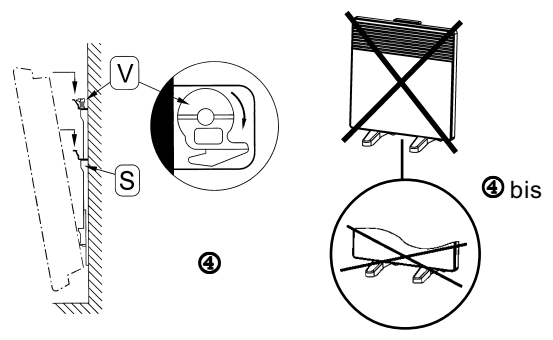
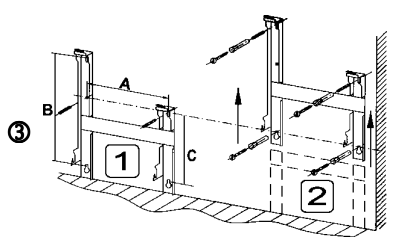
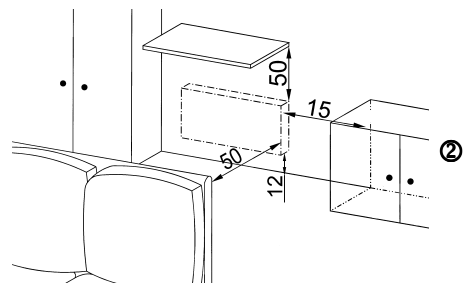
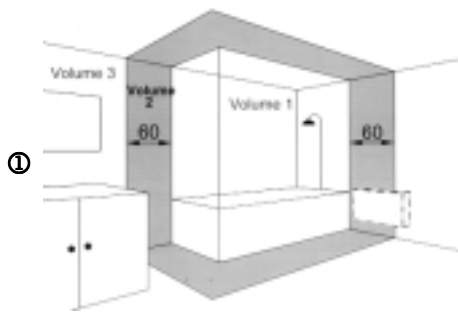

The product you have just purchased has undergone numerous tests and inspections to guarantee the highest quality. We hope it will give you entire satisfaction.

INSTALLATION OF THE PANEL HEATER

Please read the instructions before starting to install the heater. Disconnect the power before carrying out any work on the heater. Keep these instructions even once you have installed your heater.

1) Where to install your heater ?

- This equipment was designed to be installed in a residence. Please ask your distributor before using it for any other purpose.
- The panel heater should be installed according to normal trade practice and in compliance with legislation in the relevant country (the IEE Wiring Regulations).
- The equipment is class 2 and is protected against splashed water. Therefore it can be installed in volume 2, **provided the panel heater's controls cannot be reached by a person using the shower or bath.** ①
- Comply with the minimum clearance distances for positioning of the panel heater. ②
- If your wall covering is laid on foam, a spacer the same thickness as the foam must be placed under the panel heater's support. This ensures there is free space behind the panel heater to make sure its control settings are not adversely affected.
- **Do not install the panel heater:**
 - ⇒ In a draught likely to affect the control settings (under a fan, etc.).
 - ⇒ Under a fixed mains power socket.



It is strongly recommended not to install vertical products we manufacture above an altitude of 1000 metres. If the device is installed at altitude the air discharge temperature will be increased (by approximately 10°C per 1000 m of altitude). It is forbidden to install vertical product in horizontal position

2) How to install the panel heater ?

2-1) Mount the wall support

- Place the attachment lug on the floor. ③.1
- Mark the holes, to determine the position of the lower attachments.
- Raise the attachment lug, making the previously marked holes coincide so that you can locate the remaining two holes. ③.2
- Drill holes and put the inserts into place
- Fix the support.
- Mount the panel heater on mounting S as shown. Lock the lock V. ④

2-2) Connecting the panel heater

- The panel heater must be powered with 220-240V 50Hz
- The panel heater must be connected to the mains, either by a 2-wire cable (Brown = Phase, Blue = Neutral) via a power socket (Product with plug : diagram **A**) or connexion box (Mechanical thermostat : diagram **B**) ; by a 3-wire cable (Brown = Phase, Blue = Neutral, Black = Pilot wire) by means of a connexion box (version with pilote wire : diagram **C**).
- In humid areas such as bathrooms and kitchens the power socket must be installed at least 25 cm above the floor.
- The installation must be equipped with an omnipole disconnection mechanism with a break contact distance of at least 3mm.
- **Earthing is prohibited. Do not connect the pilot wire (black) to earth.**
- The heater must be installed by a qualified electrician in accordance with the local regulations. The heater and the pilot wire (black) must **NOT** be connected to earth. If the heater wire is damaged, it must be replaced by a qualified person to avoid hazard.

If a pilot or piloted panel heater is protected by 30mA differential (e.g. bathroom) the pilot wire's power must be protected on this differential.

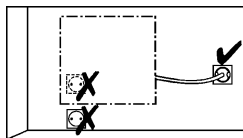

A

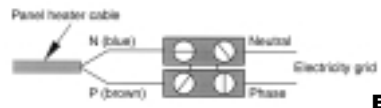

B

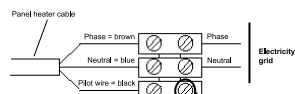

2 possible cases

- 1st case : only one heater The pilot wire free end is insulated and not further connected
- 2nd case : multiple heaters The pilot wire of all heaters in a control group, up to a maximum of 50 units with any one them used as the Master, are connected by a 1,0mm² 220-240V insulated cable

C

| Commands received | Oscilloscopes Réf/Neutral | Mode obtained | Heating temperature obtained |
|----------------------|---------------------------|---------------|--|
| No current | — | COMFORT | Comfort setting |
| Complete alternation | | ECO | ECO setting 3°C to 4°C reduction of the COMFORT setting |

USING THE PANEL HEATER

1) Description of the control unit : ⑤ and ⑥

① → ☀ (marche/1) / 0 switch (stop/0). ② → Temperature adjustment control knob. V1 → Heating indicator light

2) Fixing the comfort temperature ☀

The comfort temperature is the temperature that you would like while the room is occupied.

- Put the ① switch to ON (marche/1).
- Set the ② control knob to between 4 and 5. Electronic Model : the heating indicator V1 comes on if the room temperature is below the required temperature.
- Wait a few hours for the temperature to stabilise.
- If the setting is satisfactory (if necessary use a thermometer to check), mark the position for future use.
- If the setting is not satisfactory, adjust it and start again from point c.

3) Frost-Free mode ❄

This mode is used to keep the temperature at approximately 7°C in the room when you are absent from the house for a prolonged period (i.e. more than 24 hours).

- Leave the ① switch on ❄ / I.
- Set the ② control knob to ❄ (mechanical).

4) The heating indicator : V1 (electronic model)

This light comes on when the heating element is working. It may flash when the temperature has stabilised.

5) Locking the controls : ⑦ et ⑧

It is possible to lock or limit use of the ② control knob and lock the ① switch to prevent unauthorised manipulation of the panel heater (children, etc.).

- Unhook the panel heater from its wall mounting.
- Remove the slugs P on the back of the thermostat from their mountings.
- Select position B to lock the control knob or position L to limit the amount it can be turned. Position M blocks the switch for Electronic Model.

6) Using the pilote wire

The product with pilote wire can receive the following signal from a master unit :

- COMFORT (Temperature of ② control knob)
- ECO (Comfort temperature -3°C to 4°C)

The product must be connected through the pilote wire to a programming control or a product with K7 Program in order to use comfort or eco mode. You can thus control several convectors with a single programmer or a product with K7 Program.

RECOMMENDATIONS FOR USE

- There is no point in setting maximum heating, the room temperature will not rise any quicker.
- When you air the room, disconnect the panel heater by putting the ① switch to 0 / 0.
- If you leave for several hours, remember to reduce the temperature.
Absence for : **less than 2 hours**, do not touch the controls.
2 to 24 hours, lower the ② control knob by two graduations.
more than 24 hours or in the summer, put the ② control knob to ❄ (mechanical), the ① on ❄ (electronic).
- If you have several units in a room, let them operate simultaneously. This will give you a more uniform temperature without increasing electricity consumption.

WARNINGS



This appliance is not intended for use by young children or infirm persons without supervision. Young children should be supervised to ensure that they do not play with the appliance, lean against the front or insert objects or paper in it. Do not totally or partially block the grilles on the front or inside of the appliance, as this may cause overheating. If the supply cord is damaged, it must be replaced by a service agent or similarly qualified person in order to avoid a hazard (applies to units fitted with a supply cord and plug). Units fitted with a three core supply cord (brown, blue & black), must be directly connected to fixed wiring by a licensed electrician. All work on the interior of the appliance must be carried out by a licensed electrician.

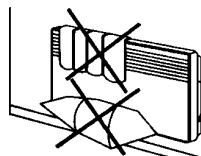

MAINTENANCE

To maintain performances of your unit, you should clean the upper and lower grilles of the unit about twice a year using a vacuum cleaner or a brush.

Have a professional check the inside of the unit every five years.

Dirt may collect on the grille of the unit if the atmosphere is polluted. This phenomenon is due to the poor quality of the ambient air. In this case, it is recommended to check that the room is well ventilated (ventilation, air inlet, etc.), and that the air is clean. The unit will not be replaced under the guarantee because of this type of dirt.

The unit casing should be cleaned with a damp cloth, never use abrasive products.

TROUBLE-SHOOTING

If the unit does not heat :

Check that the programmer is in COMFORT mode (electronical).

Make sure that the installation circuit breakers are switched on, or that the load shedder (if you have one) has not switched off the unit power supply. Check the air temperature in the room.

The unit does not carry out programming orders : (version with pilot wire)

Make sure that the programming unit is being correctly used (refer to its user's manual) or that the Chronocarte is properly inserted in its housing and that it is operating normally (batteries ?).

The unit is permanently heating :

Make sure that it is not in a draft and that the temperature setting has not been changed.

This unit with electronic control is equipped with a microprocessor that can be disturbed by some severe mains voltage disturbances (outside EC standards defining the disturbance protection level). If there are any problems (thermostat blocked, etc.) switch off the unit power supply (fuse, circuit breaker, etc.) for about 5 minutes to allow the unit to start again.

Have your energy distributor check your power supply if the phenomenon occurs frequently.

WARRANTY CONDITIONS :

KEEP THIS DOCUMENT IN A SAFE PLACE

(This certificate should only be produced if you are making a complaint, attached with the invoice of the purchase)

- This guarantee is applicable for 2 years from the date of original purchase and shall be valid for no more than 30 months from the date of manufacture.
- Your Atlantic distributor will exchange parts shown to be defective in manufacture. The replacement parts will be of charge but Atlantic does not accept responsibility for freight or labor charges or losses in transit.
- This guarantee excludes damage by neglect, shipping or accident and any damage due to incorrect installation, use or purposes other than those intended or failure to observe the instructions given.

UNIT TYPE * : _____

SERIAL NUMBER * : _____

CUSTOMER'S NAME AND ADDRESS : _____

** This information is shown on the plate which can be seen on the left-side or behind the front grille of the unit.*

FOR SALES IN NEW ZEALAND

ATLANTIC AUSTRALASIA
Phone : 0800 422 000
Fax : 04 3800 509

FOR SALES IN AUSTRALIA

ATLANTIC AUSTRALASIA PTY LTD
4/13-25 Church Street
Hawthorn Victoria 3122
Australia

Free call : 1800 677 857
Phone : 03 9852 9599
Fax : 03 9852 9844
web : www.atlantics.com.au

INSTALLER'S STAMP

FOR SALES IN THE U.K., please contact :

ATOUR ATLANTIC LTD
Malling Works, Lewes
East Sussex BN7 2AY

Phone : 01580 2431 53
Fax : 01580 2411 80
E-mail : sales@tour-atlantic.ltd.uk