

**PLMB****9KEHPW-410 / 12KEHPW-410 / 15KEHPW-410**

## SAFETY INSTRUCTIONS

### IMPORTANT!

- The unit is designed for indoor operation.
- Rating: This unit must be connected to a 220-240 V~ / 50 Hz earthed outlet.
- The installation must be in accordance with regulations of the country where the unit is used.

**If you are in any doubt about the electrical installation, have it checked and if necessary modified by a qualified electrician.**

- The air conditioner is safe. However, as with other electrical appliances, use it with care.
- This appliance is not intended for use by young children or infirm persons unless they have been adequately supervised by a responsible person to ensure that they can use the appliance properly
- Young children should be supervised to ensure that they do not play with the appliance.
- Do not clean the air conditioner by spraying it or immersing it in water.
- Do not insert any object into openings of the air conditioner.
- Disconnect it from the mains before cleaning the unit or any of its components.
- Never connect the unit to an electrical outlet using an extension cord. If an outlet is not available, one should be installed by a licensed electrician.

## WARNING

- Never operate this appliance if it has a damaged cord or plug. Do not lead the cord over sharp edges.
- A damaged supply cord should be replaced by the manufacturer, its service agent or a qualified person in order to avoid a hazard.
- Any service other than regular cleaning or filter replacement should be performed by an authorized service representative. Failure to do so could result in a loss of warranty.
- Don't lift or move by pushing the air conditioner at the rear, but always at the front side.

**Do not use your air conditioner under the following conditions:**



If the power cable wires are frayed or cut



When small children may be left unattended

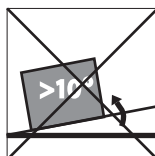

On a slope or uneven surface



Close to a naked flame



This product is not made for DIY repair



If there is a risk of liquid falling on the unit

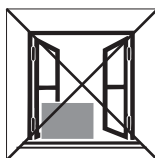

Inside unit exposed to the weather outdoors



Near water

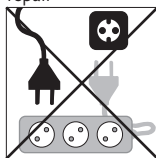

If an extension lead may become overloaded



Where the power cable may be damaged



Where it may be damaged by chemicals

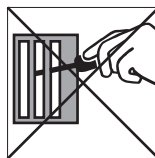

Where there is a risk of interference by foreign objects

## PARTS

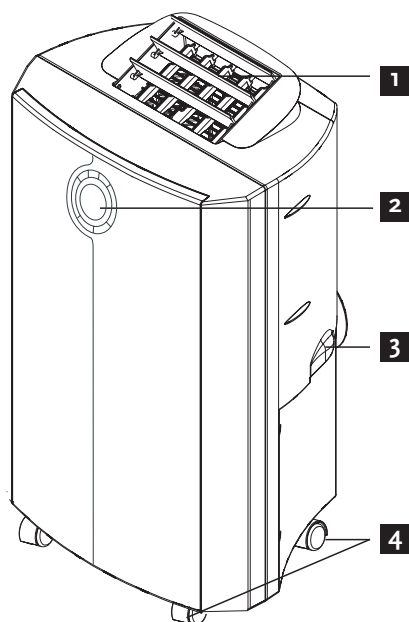

- 1. Air outlet
- 2. Control panel
- 3. Carrying handle
- 4. Caster wheels

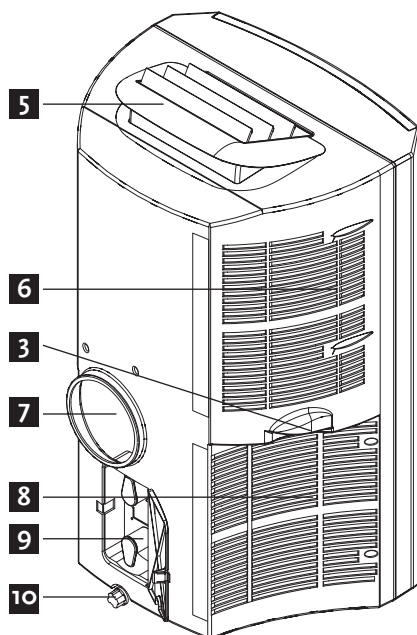

- 5. Grill housing
- 6. Upper air inlet
- 7. Exhaust air outlet
- 8. Lower air inlet
- 9. Cable storage
- 10. Drainage point with water stopper

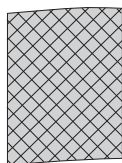

Active carbon filter

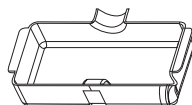
Remote control  
with LCD

Water container

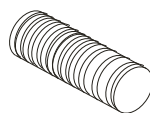

Exhaust hose

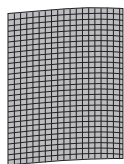
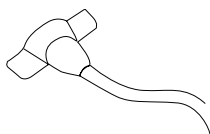
3M™ High Air Flow  
filter (Optional)Spiral Water Pipe  
with Connector

Slide bar connector

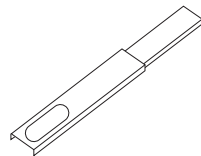

Telescopic slide bar

## CONTROL PANEL

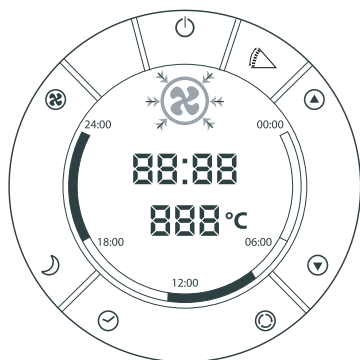

### Controls

- ON/OFF
- UP
- DOWN
- MODE
- TIMER
- SLEEP
- FAN SPEED
- SWING

### Display

- COOLING
- FAN
- HEAT
- 88:88 HOURS:MINUTES
- 888 TEMPERATURE

## AutoDrain NanoMist Technology™ Assembly

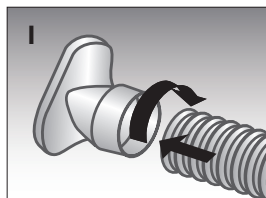

Attach Window Slide Bar Connector to Exhaust Hose by twisting as shown.

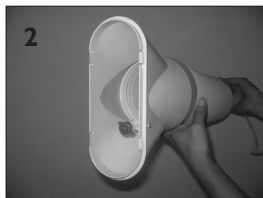

Put spiral water pipe into hot air flexible hose.

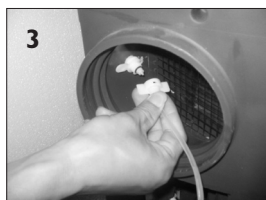

Connect the female half of the quick connector at the end of the spiral water pipe to the male part in the hot air outlet pipe.



Turn the connector 90 degrees clockwise until it is locked in place.



Assemble the hot air hose on the unit.

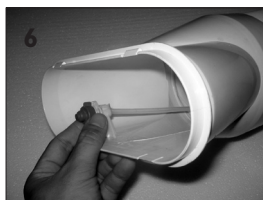

Clip on the water atomizer at the end of the spiral pipe to the holder.



Unfold flexible hose with attached hose adapter connector, and snap into Window Slide Bar.



**Only Required For Disassembly.**

In order to unlock the quick connector, push the tab and turn the connector counter-clockwise.

## INSTALLATION

### WARNING!

Before using the air conditioner it should be left in an upright position for at least 2 hours. This unit can easily be moved from one room to another.

### In doing so keep this in mind:

- Ensure that the unit is positioned upright, on a level surface and 50 cm away from any obstacles.
- To place the loose filters in the filter holder.
  - Take the filter holder out of the air conditioner.
  - Open the filter holder and place the active carbon filter (black) in the filter holder.
  - Place the filter fixing component back in the holder.
  - Place the filter holder back in the air conditioner.
- Do not operate the unit inside the bathroom, shower, or in any other very humid environment.
- Connect the hose to the unit by turning it clockwise (at least 5 turns).
- Similarly, connect the hose to the slide bar connector as far as possible.
- Place the telescopic slide bar in the open window or door and adjust the length to fill as much open space as possible.
- Put the slide bar connector in the opening in the telescopic slide bar.
- Close the window or door as much as possible to prevent outside air entering the room.
- Ensure that the slide bar connector has a free flow outside.

### IMPORTANT!







The flexible exhaust hose can be extended from 500 to 1500 mm for mounting. This length has been designed especially according to the specifications of the air conditioner. **Do not use an extension or exchange for a different hose as that may lead to malfunctioning.** The exhaust air must flow freely, any blockage can lead to overheating of the air conditioner. Take care to prevent any sharp bow or bend in the exhaust.

## OPERATION

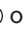

### ON/OFF

Press  to switch the unit on, or to switch off. A buzzer will beep, and the LCD will display 12:00 o'clock as default.

### Setting the clock

Press the -button for 3 seconds to set the clock. The 2 left digits of the 4 digits on the LCD-display will flash. Press  or  to adjust the hour. Press  momentarily, the 2 right digits of the 4 digits will flash. Press  or  to adjust the minutes of the clock. Press the -button for 3 seconds again to activate the clock.

### Setting the temperature



If you want to change the set temperature press the  or -button. The 2 digit display will indicate the set temperature.

**Note:** Reaching the set temperature depends on the room and outdoor climatic conditions.

### Mode



Pressing the -button successively until the icon representing the desired mode is appearing

(=> Cool => Fan => Heat => etc). On the LCD-display you will see:

Cooling  Fan only  Heat 

Each time the unit starts, it starts operating in cool mode with a set temperature of 22°C. The fan speed will be selected automatically.

### Fan speed

If you prefer a constant fan speed instead of the auto fan speed, press the -button successively; the fan speed icon  on the LCD-display will rotate accordingly.

- Fast - for the turbo speed
- Normal - for the medium speed
- Slow - for the slow speed
- Auto - alternating fast and slow speed

### Heat

With the mode switch select , set the desired temperature and the unit will heat until this temperature is reached. Fan speed is selected automatically. Do not place the unit near anything that could catch fire or be scorched. Do not obstruct the air outlet.

### Timer

For all of the following TIMER programming, proceed firstly with these standard steps:

- Press the -button briefly; the 2 left digits of the 4 digits on the

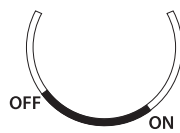

Timer example



LCD display are flashing.

- Press ▲ or ▼ to adjust the hour.
- Press the ☹-button briefly again, the 2 right digits of the 4 digits are flashing.
- Press ▲ or ▼ to adjust the minutes of the clock in intervals of 5 minutes. The timer is set. After 10 seconds the time display returns.

#### **Programming the timer for ON - when the unit is OFF.**

- Perform the standard steps as described above.

The linear time scale will be on between the ON programmed times until 24:00.

The flashing bar on the time scale indicates the real time and moves a segment ahead every 30 minutes until it reaches the ON timer time, then the black segments in the linear time scale will disappear.

#### **Programming the timer for OFF - when the unit is RUNNING.**

- Perform the standard steps as described above.

The linear time scale will be on between the present time to the OFF programmed time. The flashing bar on the time scale indicates the real time and moves a segment ahead every 30 minutes until it reaches the OFF timer time, then the black segments in the linear time scale will disappear.

#### **Repeated OFF and ON**

##### **Programming the timer for repeat OFF and ON - when the unit is RUNNING.**

- Perform the standard steps as described above.
- Repeat the above procedure while the digits are still flashing for setting the ON.

The linear time scale will be ON between 00:00 to the time set with the timer to OFF and from the ON time until 24:00. The flashing bar on the time scale indicates the real time and moves a segment ahead every 30 minutes. The unit will operate daily according to the timer setting.

#### **Repeated ON and OFF**

##### **Programming the timer for repeat ON and OFF - when the unit is NOT RUNNING.**

- Perform the standard steps as described above.
- Repeat the above procedure while the digits are still flashing for setting the OFF.

The linear time scale will be OFF between 00:00 to the time set with the timer to ON and from the OFF time until 24:00. The flashing bar on the time scale indicates the real time and moves a segment ahead every 30 minutes. The unit will operate daily according to the timer setting.

After a power failure, or after the unit has been unplugged, you will have to program the timer settings again.

#### **Cancelling the timer function**

In order to cancel the timer programming press the ☹-button momentarily, then it will return to the time display. The daily mode will be cancelled as well. The black segments in the linear time scale will disappear.

### LCD blue back light

In order to switch off the blue back light, press the ▲- and ▼-buttons at the same time. The blue back light will blink twice and goes off after three seconds.

By pushing any of the buttons the blue back light will come on again.

### Air flow

On the moment the air conditioner is connected to the mains, the louvres open and close and stay closed.

- When the ON-button is pressed, the louvres open to maximum and return to an angle of 75° above the upper plane of the louvres housing.
- Press the ▲-button, the louvres will swing continuously up and down between 30° and 80° above the upper plane of the louvres housing.
- By pressing the ▲-button again the movement will stop and the louvres remain in that position. The direction of the air flow is then constant.
- When the OFF-button is pressed, the louvres close.

This way of directing the air flow is particularly convenient when using the remote control: a user friendly approach to your comfort.

In order to direct the air flow to a lower angle, raise the louvres housing by pulling it up only by the centre of its back rim.

### Sleep mode

The sleep mode function adjusts the set temperature of the unit to the thermal

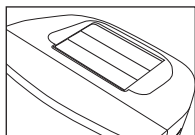

Air outlet down,  
louvres closed

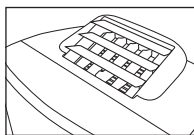

Air outlet up,  
louvres opened

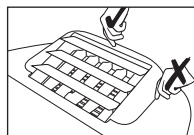

Raising the  
louvres housing.

needs of the body falling asleep as follow:

- Default fan speed: LOW
- Press the ⏸-button to operate the sleep mode. Press the ⏸-button again in order to cancel the sleep mode.  
The set temperature will increase 1°C after 1 hour and a further 1°C after 2 hours.
- No FAN mode under SLEEP mode operation.

## REMOTE CONTROL

The unit responds to all signals that are sent by the remote control. There will be a beep sound from the unit after receiving the signal. The operation of the unit by remote control, is almost identical to the operation by the control panel. The only exception is the clock function.

Instead of the ☺-button for setting the actual time and for programming the timer, there are 3 push buttons on the remote control as follows:

- ☺ - for setting the actual time.
- TIMER ON - for programming the time when the unit is ON.
- TIMER OFF - for programming the time when the unit is OFF.



## AIR FILTERS

This air conditioner is equipped with two filter sets:

1. A multi layer filter in the upper air inlet, to clean the circulated room air, which includes:
  - a. A screen filter, to remove dust particles.
  - b. An active carbon filter, to remove odours.
  - c. 3M™ High Air Flow filter; to remove unhealthy particles from the air such as pollen, bacteria, animal dander and dust. Selected models have the 3M™ High Air Flow filter as standard. However, if you require to add this to your model, or wish to purchase a replacement, call Atlantic for details.
2. A screen filter in the lower air inlet, to remove dust particles.

**NOTE!** The active carbon filter and the 3M™ High Air Flow filter are delivered in a plastic packaging. Don't forget to install these filters.

### Cleaning the air filters

- a. The screen filters in the upper and lower air inlet should be cleaned regularly by rinsing them under running water.
- b. The positive/negative electrostatically charged 3M™ High Air Flow filter is recommended to be changed every 3 months. Unusual dirt, construction work, pets, the presence of smoke and running the air conditioning unit continuously can shorten the life time of the 3M™ High Air Flow filter.
- c. The active carbon filter can be cleaned with a vacuum cleaner when dusty but has to be changed at the same time as the 3M™ High Air Flow filter.

### Filter installation

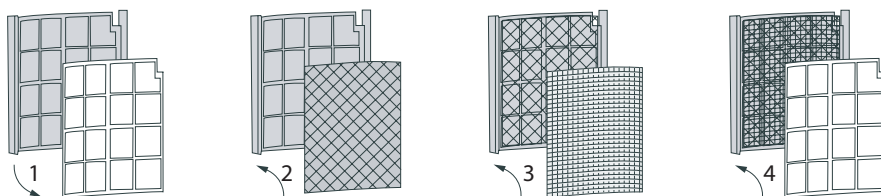

- Slide out the filter holder from the unit.
- Separate the filter fixer from the filter holder (see fig. 1).
- Remove the active carbon filter (black) and the 3M™ High Air Flow filter (white) from its plastic bag.
- Insert the active carbon filter into the filter holder (see fig. 2).
- Insert the 3M™ High Air Flow filter into the filter holder (see fig. 3).
- Fix the filter by reassembling the fixer into the filter holder (see fig. 4).

**NOTE!**

- Remove the 3M™ High Air Flow filter and active carbon filter before seasonal storage and install new filters at the beginning of the new season. The old filters can be disposed in the 'Non-biological garbage container'.
- Replacement filter packages are available directly from Atlantic.
- To run the unit without active carbon filter and/or 3M™ High Air Flow filter does not do any harm to the air conditioner. In this case odours and unhealthy dust are not removed from the circulated air.
- The screen filter must always be used.
- 3M™ is a trademark of the 3M Company.

## EMPTYING THE INTERNAL WATER CONTAINER

**This air conditioning does not require emptying of the water container, except prior to season end storage.**

**This portable AC features the Innovative AutoDrain NanoMist Technology™.**

Very little excess water should accumulate. During the process of cooling, some of the water accumulated is actually used to cool the unit internally, making it run more efficiently. Both this evaporative technology and Innovative AutoDrain NanoMist Technology™ are features not found in most portable air conditioners.

To empty the water container do the following:

- Switch off the unit and remove the plug from the wall socket.

**Do not move the unit. Doing this can result in water leakage, damaging your floor or carpet.**

- Place the water container on the floor underneath the permanent drainage point.
- Remove the water stopper and rubber plug from the drain and let the water run out. The water container has to be emptied several times before all water will be drained (ca. 1.5 litres).
- Replace the rubber plug and water stopper, put the plug into the wall socket, and switch the unit on. The warning signal should be off.

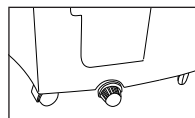
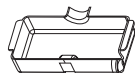
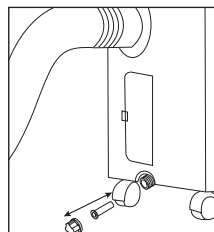

## CLEANING

**WARNING!** First of all switch off the unit and remove the plug from the wall socket.

Clean the housing with a soft, damp cloth. Never use aggressive chemicals, petrol, detergents or other cleansing solutions.

Clean the screen filter regularly with a vacuum cleaner. See also “AIR FILTERS” section.

**NOTE!** Never use the air conditioner without the screen filter.

## TROUBLE SHOOTING

| Never try to repair or dismantle the air condition yourself. Incompetent repairs result in loss of warranty and can endanger the user and the property.            |  |  |
|--|--|--|
| Problem  | Cause  | Solution   |
| The air conditioner does not function.   | No power supply.   | Connect to a functioning outlet and switch on.                                   |
|  | Is the LCD light flashing.                                       | Empty the internal water container.  |
|  | Timer function is active.  | Deactivate TIMER function.   |
| The air conditioner does not seem to perform.  | In direct sunlight.  | Close curtains.  |
|  | Windows or doors open, many people or a heat source in the room. | Close doors and windows, place an extra air conditioner.                         |
|  | Dirty filter.  | Clean or replace the filter(s).  |
|  | Air inlet or air outlet blocked.                                 | Remove the blockage.   |
| The unit is noisy.   | Room temperature lower than the selected value.                  | Change temperature selection.  |
|  | Unit stands uneven.  | Place on an even, solid surface (less vibrations).                               |
| The compressor does not work.  | The overheat protection is probably activated.                   | Wait 3 minutes until the temperature has decreased, then turn on the unit again. |
| The remote control does not function.  | Distance too great.  | Make sure the remote control is correctly aimed at the control panel.            |
|  | Remote control signal not detected by the control panel.         |  |
|  | The batteries are drained.                                       | Replace the batteries.   |
| To correct problems that have not been described in the table and/or if the recommended solutions fail to solve the problem, contact an authorized service centre. |  |  |

## STORAGE

- Empty the internal water container.
- Clean the screen filter.
- Remove the active carbon filter before end of season storage and install new filters at the beginning of the new season.
- The old filters can be disposed of in the 'Non-biological rubbish container'.  
Replacement filter packages are available from Atlantic.
- Put the unit in Fan Only mode for a few hours to ensure that the inside becomes completely dry.
- Store the cable as shown.

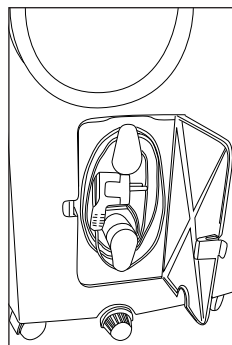

Protect the unit against dust and store in a dry place, not accessible to children.

## TECHNICAL DATA

| Model                                  |             | PLMB<br>9KEHPW-410   | PLMB<br>12KEHPW-410 | PLMB<br>15KEHPW-410 |
|--|-------------|----------------------|---------------------|---------------------|
| Cooling capacity                       | BTU/h       | 9000                 | 12000               | 15000               |
|  | KW          | 2.6                  | 3.5                 | 4.4                 |
| Heating capacity                       | BTU/h       | 9500                 | 12500               | 15500               |
|  | KW          | 2.8                  | 3.7                 | 4.5                 |
| Power consumption -Cooling<br>-Heating | W           | 850                  | 1100                | 1500                |
|  |             | 900                  | 1200                | 1400                |
| Current -Cooling                       | A           | 3.7                  | 4.8                 | 6.5                 |
| Current -Heating                       | A           | 3.9                  | 5.2                 | 6.0                 |
| Mains                                  | V / Hz / PH | 220 - 240 V~/ 50 / 1 |                     |                     |
| Compressor model                       |             | Rotary               |                     |                     |
| Fan speeds                             |             | 3 (2+1 turbo)        |                     |                     |
| Thermostat range                       | °C          | 18 - 32              |                     |                     |
| Operating temperature range            | °C          | 5 - 35               |                     |                     |
| Refrigerant / R410A                    | g           | 340                  | 560                 | 660                 |
| Dimensions (w x h x d)                 | mm          | 500 x 815 x 415      |                     |                     |
| Net weight                             | kg          | 31.2                 | 35                  | 35.8                |

PLMB 9KEHPW-410 series can be connected only to a supply with system impedance no more than 0.210 Ohm.

PLMB 12KEHPW-410 series can be connected only to a supply with system impedance no more than 0.130 Ohm.

PLMB 15KEHPW-410 series can be connected only to a supply with system impedance no more than 0.110 Ohm.

If necessary, please consult your supply authority for system impedance information.

Subject to modifications without prior notice. For greater precision, please refer to the rating label placed on the product.



### Reminder:

Waste electrical products must not be disposed of with household waste.

This product should be taken to your local recycling centre for safe treatment.

## **YOUR GUARANTEE**

### **DOMESTIC AIR CONDITIONERS**

If this product is found to be defective as a result of faulty materials or workmanship within two years from date of purchase, it will be repaired or replaced free of charge.

*The purchaser is responsible for sending/returning the unit to/from an approved repairer.*

*Products are non-refundable 14 days from date of purchase.*

#### **This guarantee is subject to the following terms:**

Atlantic Australasia, must be notified of the fault

Proof of purchase must be presented to Atlantic Australasia's nominated representative

The warranty will be void if the product is modified, misused or repaired by an unauthorised person

The guarantee does not cover accidental damage, misuse, or consumable items such as filters

The guarantee after repair or replacement will not be extended beyond the original two-year period

All replacement parts or units will be new or reconditioned

Parts or units, which are replaced, become the property of Atlantic Australasia

Atlantic Australasia disclaims any liability for incidental or consequential damages

The warranty applies for the use of the product in Australia and New Zealand.

This GUARANTEE is in addition to your Statutory Rights.

#### **Atlantic Australasia Pty Ltd**

Suite 4, 13-25 Church Street, Hawthorn, Victoria, Australia 3122

Ph. (03) 9852 9599    Fx. (03) 9852 9844    Email: [ss@atlantics.com.au](mailto:ss@atlantics.com.au)

#### **Atlantic Australasia**

Ph: 0800 422 000    Fx: 04 3800 509    Email: [sales@atlantics.co.nz](mailto:sales@atlantics.co.nz)    Web: [www.atlantics.co.nz](http://www.atlantics.co.nz)